

Accessory Electric Heater Comparison

Electrical Design: Components and Features - “Differences”

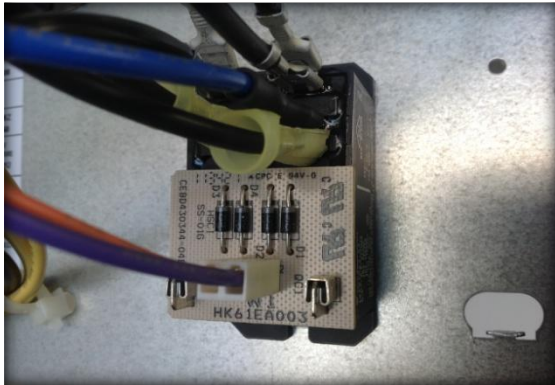

Feature	No	Yes
Each element controlled by a chatter and rapid-cycle resistant contactor	✓	
Time delay between stages which recycles on power interruption or brown-out	✓	
100% fail safe back-up safety limit, non-mechanical, field replaceable	✓	

Feature	No	Yes
Each element controlled by a chatter and rapid-cycle resistant contactor		✓
Time delay between stages which recycles on power interruption or brown-out		✓
100% fail safe back-up safety limit, non-mechanical, field replaceable		✓

NO back-up protection

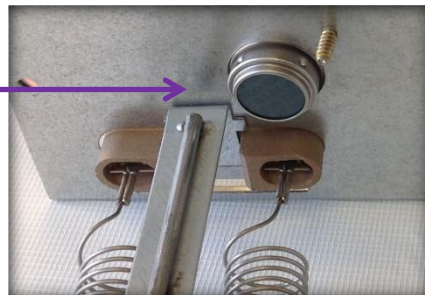

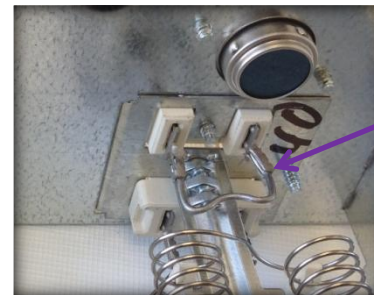

100% back-up protection



Vs.

Accessory Electric Heater Comparison

Overall Assessment

Points of Comparison		
Electric heater specifications and performance	√	√
Packaging - Actual size of the box the heater is shipped in		√
Packaging - Kit contents security (manual, wiring diag., rating sticker)		√
Chassis Design/Fabrication - Element protective frame		√
Chassis Design/Fabrication - Element support system		√
Chassis Design/Fabrication - Element field serviceability and replacement		√
Electrical Design; Components & Features - Compatibility, plug, tested, etc.	√	√
Electrical Design: Components & Features - One contactor per element		√
Electrical Design: Components & Features - Brown-out delay between stages		√
Electrical Design: Components & Features - Fail safe back-up safety limit		√
Design: Components & Features - Airflow Measuring and Monitoring		√
Accessibility & Flexibility: Manufacturer provides instant support with any questions on the product, literature, stickers, etc.		√
Accessibility & Flexibility: Manufacturer constantly helps with the development of non standard KW and voltage heaters to meet distributor needs.		√
Accessibility & Flexibility: Manufacturer has consistent On-time Delivery of the products but is also very responsive on producing/shipping unscheduled orders		√

